

Installation Instructions

Series 110.2

PHOTONIC.
LIGHTING SOLUTIONS

1. Lever end caps using clips on each side

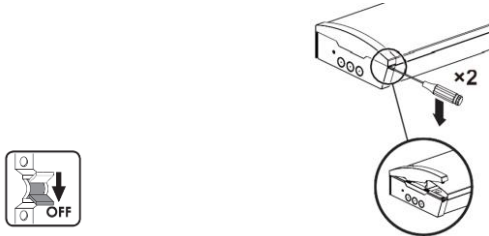

2. Completely remove end caps, keep for later.

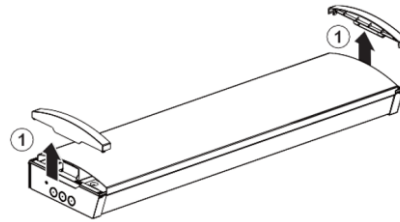

3. Squeeze edge of diffuser and lift up from unit.

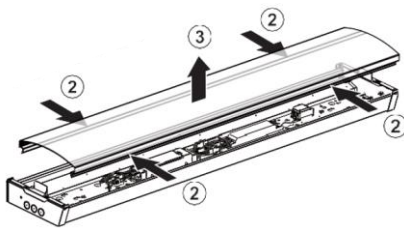

4. For surface mount, see mounting location below

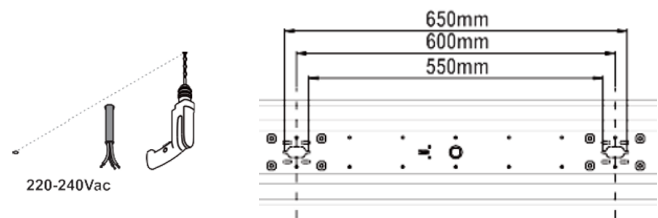

5. For suspension, use holes as indicated.

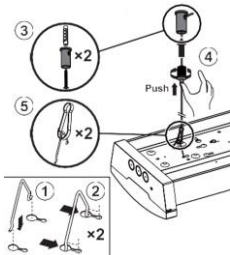

6. Insert cable through rear or side mount as required.

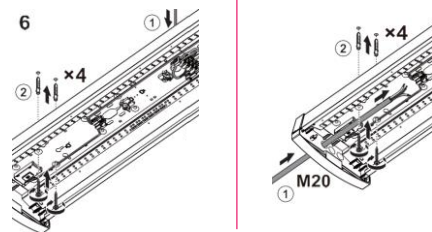

7. Connect the driver in accordance with electrical regulations

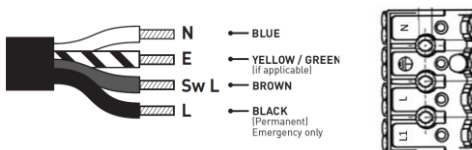

8. Squeeze diffuser and push back in place onto luminaire

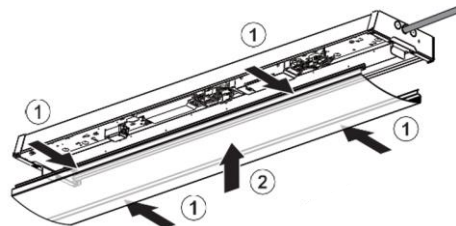

9. Click end caps in place.

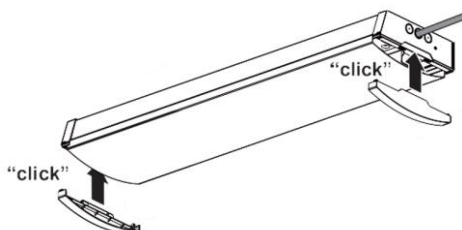

10. Switch on Power

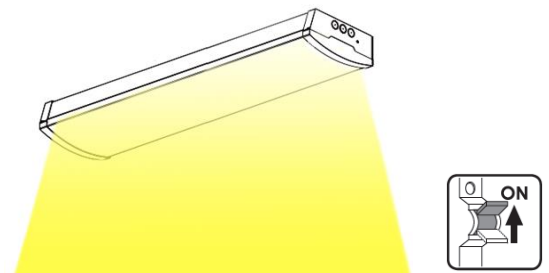

01282 476600 | info@photonighting.co.uk

Unit 1 Boran Court, Network 65, Hapton, Burnley BB11 5TH

www.photonighting.co.uk